

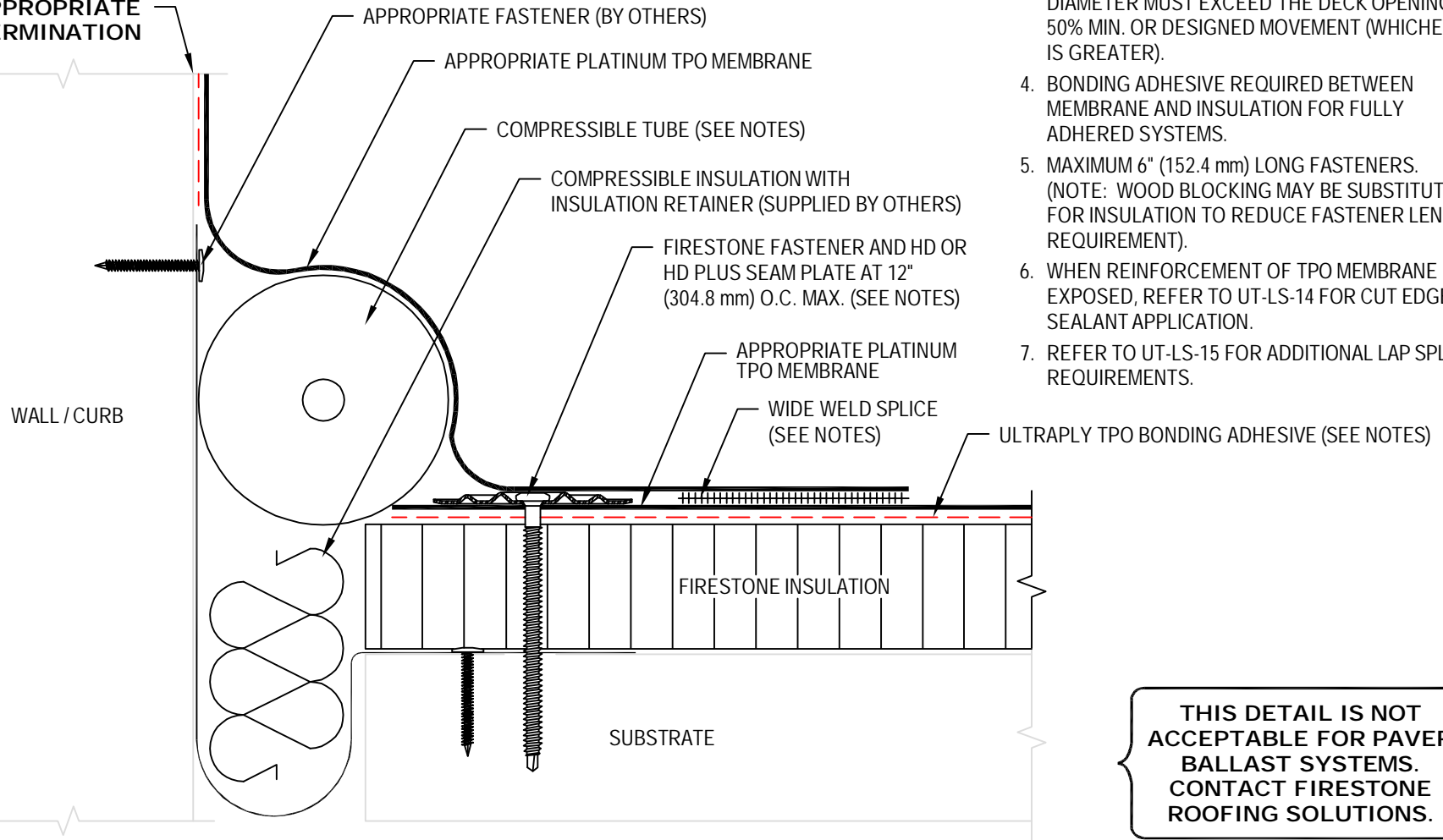

USE APPROPRIATE TERMINATION



NOTES:

1. REFER TO FIRESTONE WEBSITE FOR MOST CURRENT INFORMATION.
2. REFER TO DETAIL PUT-LS-1 OR 3 FOR WELD WIDTH.
3. COMPRESSIBLE TUBE (SUPPLIED BY OTHERS) DIAMETER MUST EXCEED THE DECK OPENING BY 50% MIN. OR DESIGNED MOVEMENT (WHICHEVER IS GREATER).
4. BONDING ADHESIVE REQUIRED BETWEEN MEMBRANE AND INSULATION FOR FULLY ADHERED SYSTEMS.
5. MAXIMUM 6" (152.4 mm) LONG FASTENERS. (NOTE: WOOD BLOCKING MAY BE SUBSTITUTED FOR INSULATION TO REDUCE FASTENER LENGTH REQUIREMENT).
6. WHEN REINFORCEMENT OF TPO MEMBRANE IS EXPOSED, REFER TO UT-LS-14 FOR CUT EDGE SEALANT APPLICATION.
7. REFER TO UT-LS-15 FOR ADDITIONAL LAP SPLICE REQUIREMENTS.

THIS DETAIL IS NOT ACCEPTABLE FOR PAVER BALLAST SYSTEMS. CONTACT FIRESTONE ROOFING SOLUTIONS.

MAXIMUM WARRANTY: 30 YEARS	
ISSUE / REVISION DATE: 3/8/2006	DETAIL NO. PUT-E-2
NOT TO SCALE	

Firestone
BUILDING PRODUCTS
NOBODY COVERS YOU BETTER.™
www.firestonebpc.com

EXPANSION JOINT (FIELD FABRICATED) WITH WELDED SPLICE ROOF TO WALL

PLATINUM ULTRAPLY™ & REFLEXEON TPO

ACCEPTABLE SYSTEMS: ALL